

RILEY TOWNSHIP PUTNAM COUNTY, OHIO

STATE ROADS
COUNTY ROADS
TOWNSHIP ROADS

T 1 S - R 8 E
2010

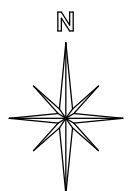

TERRENCE R. RECKER COUNTY ENGINEER

SCALE: 1" = 2640'

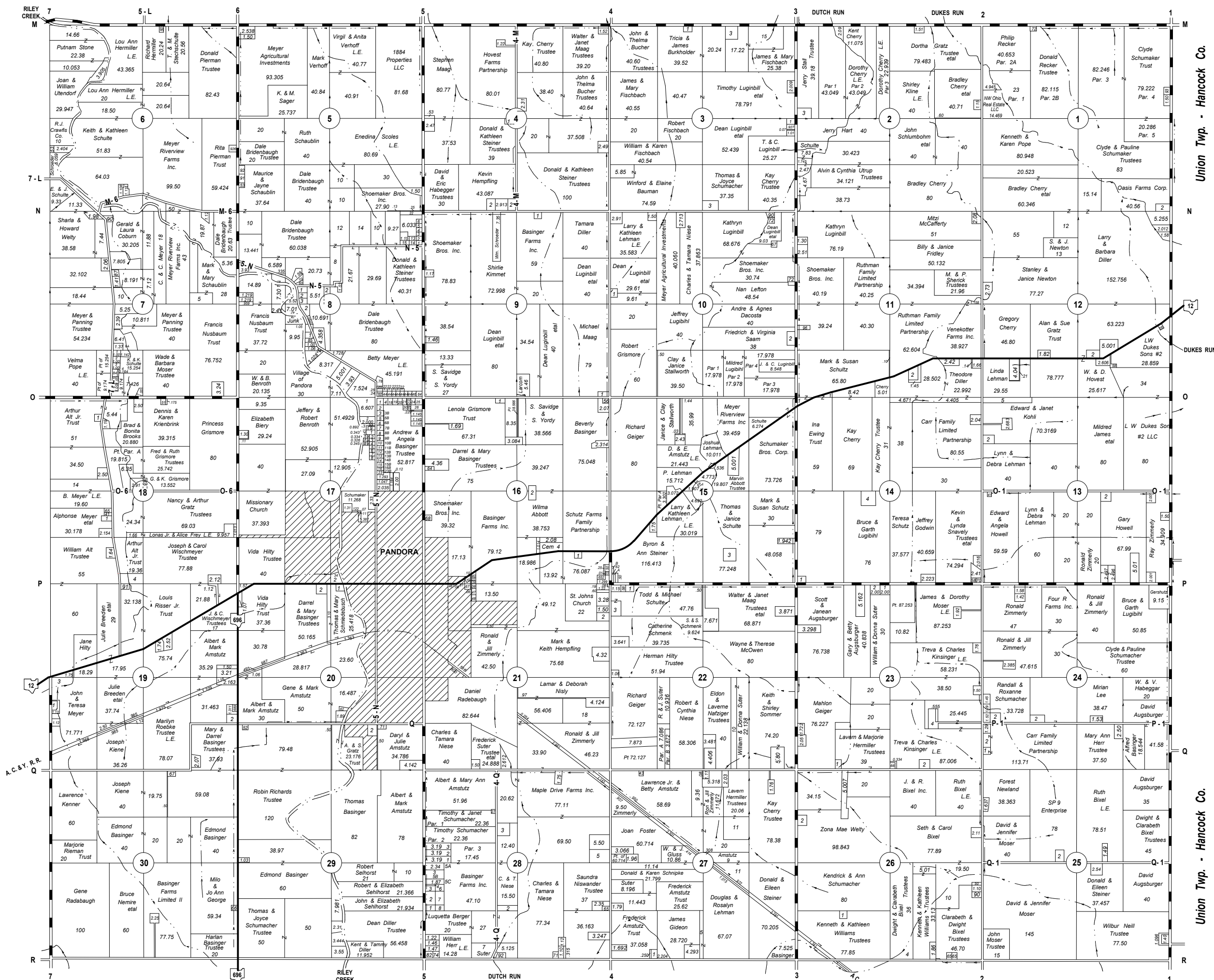

Richland Twp. - Allen Co.

Richland Twp. - Allen Co.